

1004D3/1005E3 API Bottom Loading Coupler

H32094PA
June 2008

The 1004D3 is the standard in “drip-less” bottom loading couplers and a proven performer at major oil terminals worldwide. The 1004D3 mates with all 4” bottom loading adaptors built in accordance with API RP-1004 requirements to significantly reduce liquid loss at disconnect.

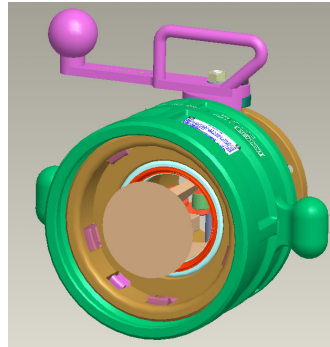

1005E3
Small handles used
Throughout Europe

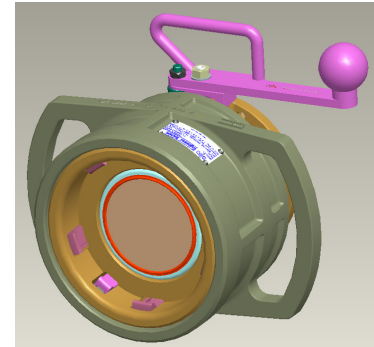

1004D3
Large handles used
Throughout the Americas

BENEFITS

5 Cam Design

Design insures easy alignment, tight connection and resists side forces during loading.

Fully Interlocked

The 1004D3 cannot be opened unless it is properly connected to an API adaptor nor can it be disconnected when the poppet is open.

Easy and inexpensive to maintain!

Redundant Sealing

Simple and reliable, consisting of dual heavy duty cross-section o-rings.

Smoother, Easier Operation

Built-In roller bearing handle and Teflon impregnated poppet and cylinder provide for smoother, easier movement.

SELECTION GUIDE

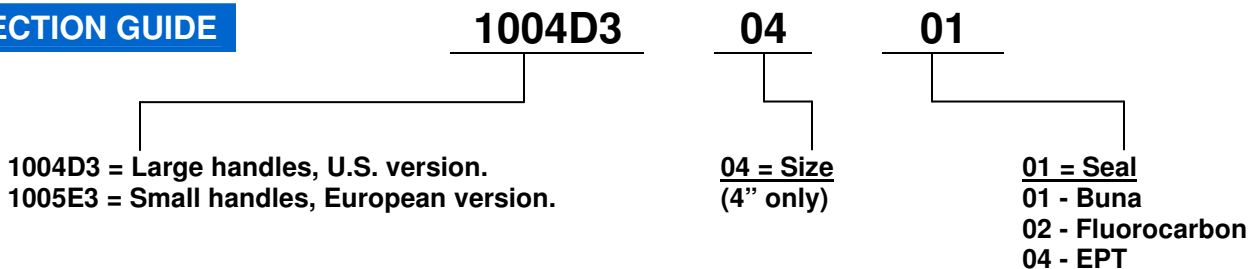

Design Parameters:		Materials:	
Max Design Pressure:	125 psi (g), 8.6 bar(g)	Body, Sleeve, Poppet	Aluminum (A356-T6)
Max Allowable Working Pressure:	75psi (g), 5 bar (g)	Cam , Interlock	316 SST ASTM A351 CF8M
Max Flow Rate:	600GPM, 135 M3/H	Cylinder	Aluminum (6061-T6)
Max Temperature:	See seal options (page 3)	Shaft	13-8 Condition RH 950 Stainless Steel.
Weight:	18.5lbs (8.39 kg)	Seals	See Seal Options
Pressure Drop (At Max Flow Rate)	2-5 psi (g), .24 bar (g)	Clevis Pin	17-4 PH SST condition H900 Hardened.

*Unit tested to 300 psi (21 bar) in the closed position to withstand excessive thermal expansion. Reference API Standard RP-1004 for additional information.